



AKHILAPRIYA™  
PROPERTIES

WE BUILD YOUR DREAM  
HOME WITH PASSION



BEST CHOICE FOR BETTER LIVING

*Pristine* 

MARKETED BY



**Invest Peer**

# INVEST NEAR INDIA'S FASTEST GROWING SEZ SRI CITY AN ECO LIFE AWAITS YOU IN A CARBON NEUTRAL ZONE

**NO DEVIATIONS**  
CONSTRUCTION AS PER DTCP APPROVED PLAN

## ABOUT AKHILAPRIYA PRISTINE

AKHILAPRIYA PRISTINE IS SURROUNDED BY ONE OF THE FASTEST GROWING SEZ IN INDIA, THE BEST OF INTERNATIONAL COMPANIES, SCHOOLS AND HOSPITALS IN SRI CITY, TADA. SOME OF THEM INCLUDE CHINMAYA MISSION SCHOOL, IIIT, KREA UNIVERSITY, GREAT LAKES INTERNATIONAL UNIVERSITY, OME UNIVERSITY ETC. NEAREST RAILWAY STATION IS LOCATED IN TADA. AKHILAPRIYA PRISTINE IS ALSO VERY SUITABLE FOR THOSE LOOKING FOR APARTMENTS NEAR SRI CITY. PRISTINE OFFERS 2 BHK APARTMENTS WITH BUILD-UP AREA OF 1,108 SQFT EAST & WEST FACING APARTMENTS APPROVED BY DTCP AMARAVATHI GUNTUR. THE PROJECT OFFERS EXCELLENT CONNECTIVITY TO CHENNAI INTERNATIONAL AIRPORT AND TIRUPATHI INTERNATIONAL AIRPORT.



# SITE PLAN

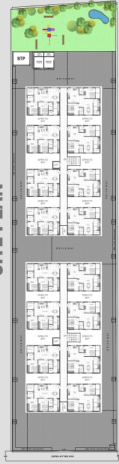

# TYPICAL FLOOR PLAN



# UNIT PLAN

## EAST FACING UNIT - 1108 SQFT



11" X 13" HALL & LIVING  
 9" X 15" DINING  
 11" X 10.6" MASTER BEDROOM  
 7" X 4" TOILET  
 10.6" X 10" KIDS BEDROOM  
 6" X 5" TOILET  
 11" X 6" KITCHEN  
 4" X 4" UTILITY  
 10" X 4" BALCONY

## WEST FACING UNIT - 1108 SQFT



# SPECIFICATIONS

## STRUCTURE

Cement concrete as per the advice from structural engineers.

## SUPER STRUCTURE

Good quality red clay bricks with cement mortar.

## DOORS

Teak wood frame panel shutter for main door. Wooden frames with flush doors for all other internal doors.

## WINDOWS

UPVC Shutters with plain glass and safety grill.

## FLOORING

Vitrified tiles of Johnson or equivalent with skirting for all rooms. Anti - skid ceramic flooring for toilets.

## PAINTING

Plastic emulsion paint for internal & external walls, Enamel paint for wood work and grills.



## KITCHEN

Granite platform with built-in Stainless Steel sink with 2' height glazed tiles over kitchen platform.

## WATER SUPPLY

Softner connected Borewell with overhead water tank.

## ELECTRICAL

Concealed 3 phase copper wiring with finolex or equivalent with necessary points like TV, Geysers, Fridge, Telephone points etc.. and adequate light and fan points with modular switches of Anchor, Roma or equivalent in living area, bed and kitchen.

## TOILET

CP Faucets of reputed brand and European WC, wash basin of superior quality like Parryware or equivalent. GI/PVC of ISI specifications. Provision for hot & cold water. 7' height dado work with glazed tiles in bathrooms.

## LIFTS

Kone, Johnson, Otis or equivalent brand.

## POWER BACK-UP

Common areas, Lift and 2 points for each units.

## CAR PARKING

covered Car parking for each flat.

# ABOUT SRICITY

Sri City, which was founded in 2008 in one of India's most backward districts, has now become one of the coveted business destinations in the country with total investments close to 4 billion USD and total exports exceeding 500 million USD till date. Sri City is a planned integrated business city (township) located 55 km north of Chennai on NH 16 in the state of Andhra Pradesh, India. Much of the Sri City area is in Chittoor District and a smaller area along the NH16[3] is in Nellore District of Andhra Pradesh, India. Sri City boasts of seamless connectivity by road, air and sea ports.



## LOCATION MAP



## PLACES NEAR BY

- 60KM CHENNAI INTERNATIONAL AIRPORT
- 70KM TIRUPATI INTERNATIONAL AIRPORT
- 2KM TADA RAILWAY STATION
- 3KM SRI CITY
- 15 KM SULURPET RAILWAY STATION
- 3KM FRONTIER LIFELINE HOSPITAL SRI CITY
- 3KM IIIT SRI CITY
- 3KM CHINMAYA VIDYALAYA
- 3.5KM MANGO RESORTS

## AKHILAPRIYA PROPERTIES PRIVATE LIMITED

#4B, PLOT NO.11B, 7TH STREET, NEW COLONY, ADAMBakkam, CHENNAI - 600088

SITE ADDRESS : CHEDULAPAKKAM VILLAGE, BATHALAVALAM GRAMA PANCHAYAT, VARADAIHPALEM MANDAL, CHITTOOR DISTRICT, ANDHRA PRADESH